

Self-Guided Tour Map

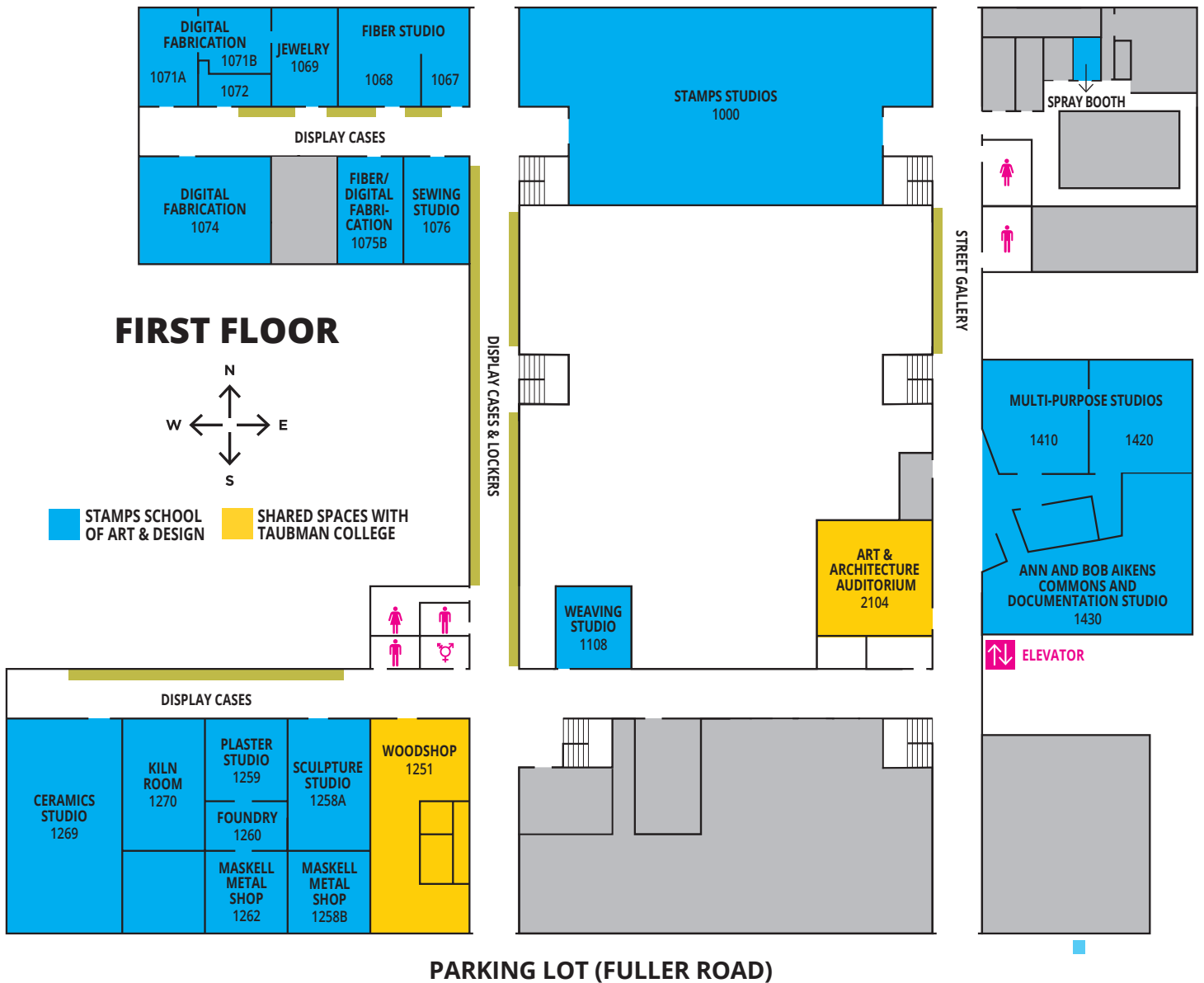

M STAMPS
SCHOOL OF ART & DESIGN
UNIVERSITY OF MICHIGAN

BONISTEEL BOULEVARD



PARKING LOT (FULLER ROAD)

Ann and Bob Aikens Commons - 1430

- An open space for students to work on projects, store materials, and collaborate. Includes a documentation studio.

Ceramics Studio - 1269

- Studio space for hand building, wheel throwing, slipcasting, and all glaze work.

Digital Fabrication - 1071, 1072, 1074

- Focuses on 3D printing, CNC milling/routing, vinyl cutting, digital embroidery, and laser cutting.

Fiber Studio - 1067, 1068

- Equipment for printing, weaving, dyeing, and screen-printing.

Fiber/Digital Fabrication - 1075B

- These spaces include new digital looms, screen printing, and more.

Foundry - 1260

- Equipped for ceramic shell lost-wax casting in bronze or aluminum.

Jewelry - 1069

- Focuses on a variety of metal work, including small metals, jewelry, and larger metalwork.

Kiln Room - 1270

- Includes electric, gas, and outdoor kilns.

Maskell Metal Shop - 1258B, 1262

- Equipment for steel and aluminum fabrication, welding and forging, and water jet and CNC plasma cutters.

Multi-Purpose Studios - 1410, 1420

- Designed for creative practice in different mediums, these are spaces for collaboration.

Plaster Studio - 1259

- Space for all mold-making and ceramic shell casting.

Sculpture Studio - 1258A

- Studio space for construction and finishing projects.

Sewing Studio - 1076

- 20 sewing machines for 2D and 3D work.

Stamps Studios - 1000

- Students who participate in art exhibitions as part of their degree program are given their own 10'x10' studio space to create and install exhibits.

Weaving Studio - 1108

- "The loom room" holds over 20 looms.

Wood Shop - 1251

- A place to get your hands on traditional woodworking machinery and hand tools. Also home to machinery for metal and plastic work and two CNC laser cutters.

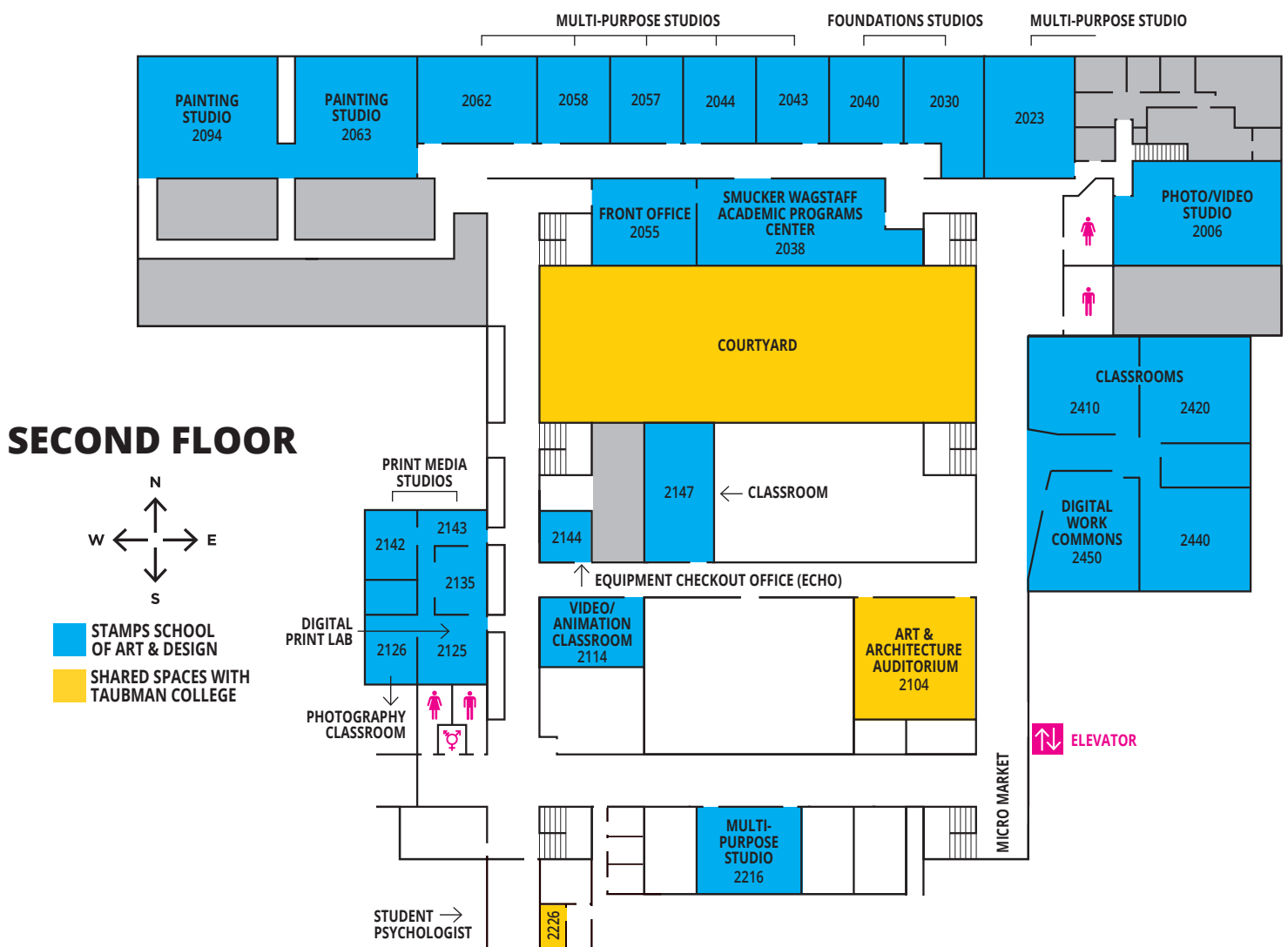

Art & Architecture Auditorium - 2104

- Lecture-style courses are taught here.
- Shared with Taubman College.

Classrooms - 2126, 2147, 2410, 2420, 2440

- Space for instruction and critiques.

Courtyard

- An open, shared space for students to gather, study, or simply hang out.

Front Office - 2055

- The official Stamps School entrance.

Digital Print Lab - 2125

- 11 archival-quality Epson printers, one 24" large format printer, all calibrated for the best possible color accuracy.

Digital Work Commons - 2450

- An open space that hosts a variety of advanced image printing processes, including inkjet, laser, Risograph, and UV printing.

Equipment Checkout Office (ECHO) - 2144

- A wide variety of gear is available for students to check out, including cameras, lights, tripods, and microphones.

Foundations Studios - 2030, 2040

- These are spaces for first-year students to take a variety of courses to build a foundation for their Stamps degree.

Multi-Purpose Studios - 2023, 2043, 2044, 2057, 2058, 2062, 2216

- Designed for creative practice in different mediums, these are spaces for collaboration.

Painting Studios - 2063, 2094

- Ventilated for safe oil painting.
- Space in 2063 for large-scale work.

Photo/Video Studio - 2006

- Used for photo projects, photo shoots, photographing/documenting work.
- Student lighting, backdrops available.

Print Media Studios - 2135, 2142, 2143

- Includes lecture/work space, etching press, acid room, areas for photo processes, and lithography presses with library of 75 stones.

Smucker Wagstaff Academic Programs Center (SWAPC) - 2038

- Academic advisors' offices are here.
- The Stamps Career Development Coordinator and the Director of International Study Programs are here.

Student Psychologist - 2226

- Embedded psychologist for Stamps and Taubman College, provides free and confidential therapy to enrolled students.

Video/Animation Classroom - 2114

- For time-based media classes.
- Computers with a range of software for complex animations and editing projects.
- Color-calibrated displays.



Questions? Email us!

stamps-admissions@umich.edu

